

RINGCENTRAL APP: USING THE CALL PARK FEATURE

Call Park is a feature that allows RingCentral app users to place a call in a Public Call Park location and have a different user pick up the call, by dialing the park location extension generated by the system.

PLACE A CALL IN A PUBLIC PARK LOCATION

During an active call, follow these steps to place the call in a public park location.

1. Click **More**.
2. Click **Park**. Then, take note of the park location extension that the system displays.

Note: Call park location extensions are automatically generated, with ranges from *801 to *899.

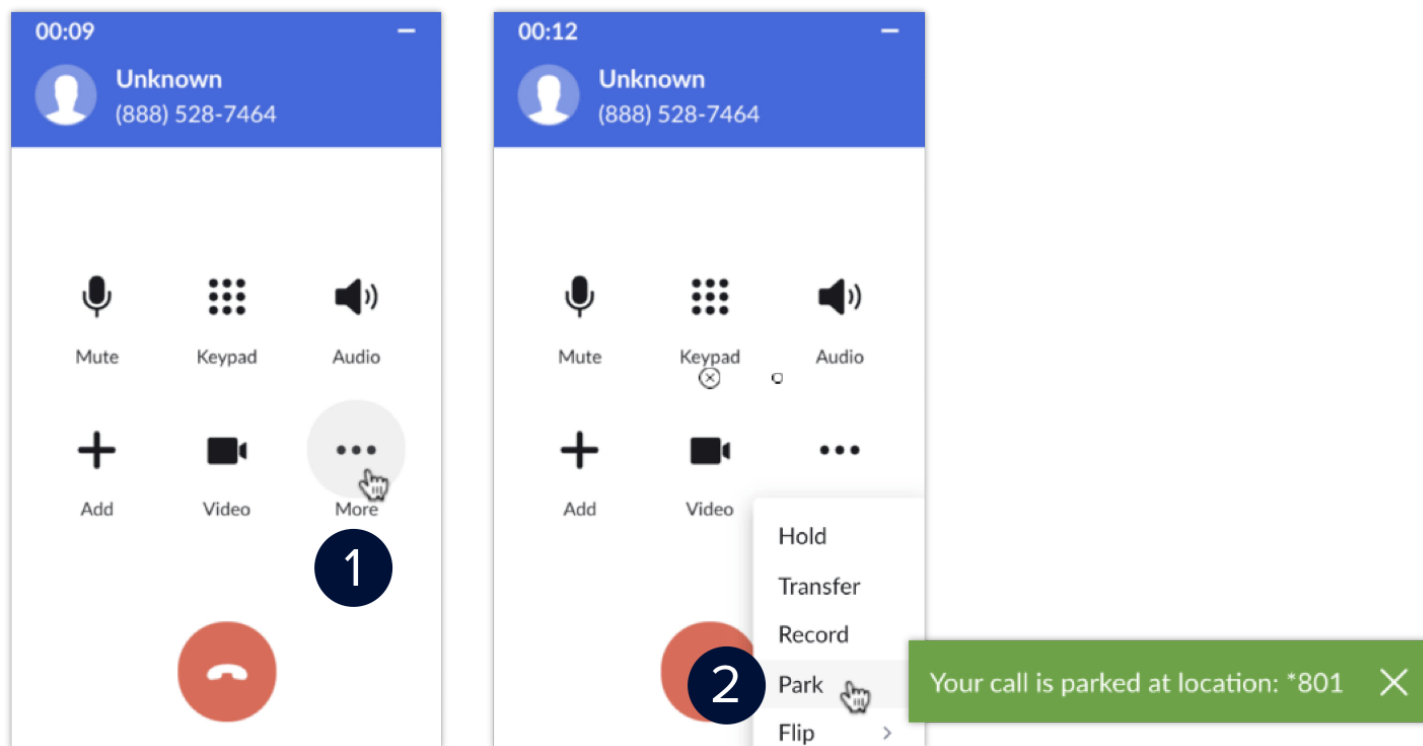

RETRIEVE A CALL FROM A PUBLIC PARK LOCATION

Follow these steps to retrieve a call from a public park location:

1. Enter the appropriate park location extension of the call you want to retrieve using the dial pad.
2. Click the **Dial** button.

